

A stone wall sign for the University of California, Irvine. The sign is made of light-colored rectangular stones and features the university's name in large, dark, serif letters. To the left of the main text is a circular seal of the University of California. The sign is set against a background of lush green trees and tall grasses in the foreground.

University of California, Irvine

Annual Zone Crew Refresher Training

UCI Division of Finance and Administration | With U • For U

Zone Crew Updates & Changes

Current Zone Crew Issues	New Zone Crew Changes and/or Updates
High overturn and not enough people willing to volunteer and fulfill all roles	**NEW** Emergency Response Procedures video hosted on UCLC. The video will be mandated for all students, faculty and staff to view annually. This video will allow us to no longer host the role of Floor Warden. Now, all staff, students and faculty will understand their roles and responsibilities during an evacuation or emergency.
Excessive list of responsibilities for Zone Captains and Building Coordinators	**NEW** Motto: “Evacuate & Communicate”. **NEW** Simplified task and processes will remove the demand to be responsible for an evacuation but rather a leader in the building’s emergency response procedures, resources, and trainings.
Not enough engagement	We began utilizing monthly BFMI meetings to increase engagement.
Not enough training	Removing Floor Wardens, excessive roles and responsibilities and simplifying roles and responsibilities within Zone Crew will allow us to increase our training and exercise opportunities.
Difficulty updating building and zone contact lists	**New** Database for all our Volunteer Emergency Response Groups to manage their own profile, alerts and notifications. This addition removes the obligation to maintain contact lists by Building Coordinators and Zone Captains.

Simplified Zone Crew Tasks

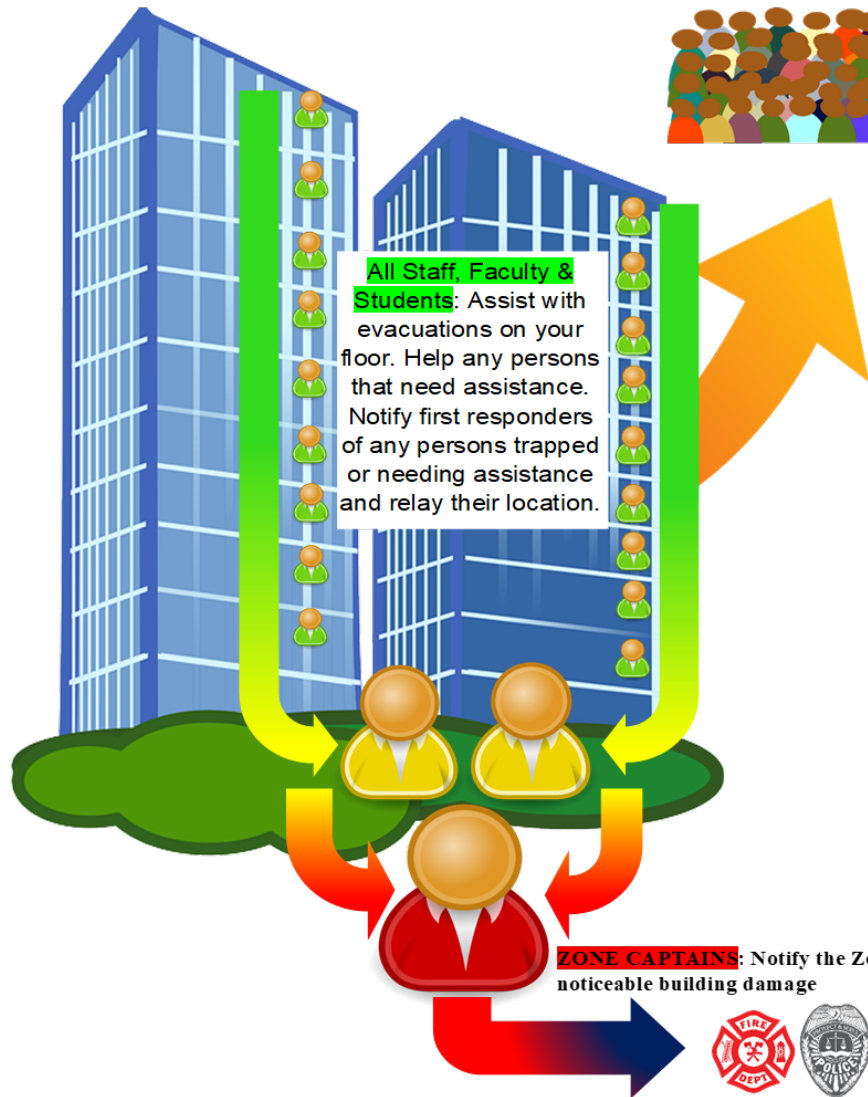

Evacuate to an assembly area away from the building and first responders. Do not enter building until told to do so by the Police or Fire Department. Begin supervisor check in accountability.

Building Coordinator Task During an Evacuation:

- Evacuate the building
- Is anyone trapped?
 - If so, note their location
 - Notify first responders of the trapped person/s?
- Are evacuees away from the building and away from first responders?

Building Coordinator Task Post Evacuations:

- Are there any obvious damages to the building's exterior or interior?
 - Broken windows
 - Cracks in the building
 - Fallen ceiling tiles
- Relay damage information to the to Zone Captain or Zone Crew Manager
- Initiate post-evacuation check-in and accountability



Post Evacuation: Assembly Area, Supervisor Check-In



- Once you have safely arrived at an assembly area, check in with your supervisor.
- Supervisors should engage in obtaining accountability for **their** staff.
- Report either 100% accountability to Building Coordinator or Zone Crew member.
- If your building has evacuated to multiple assembly areas, establish contact via cell phone to assist with Supervisor Check In if necessary.
- If anyone is missing or unaccounted for and you believe they may still be inside of the building, report that to a first responder or Building Coordinator/Zone Captain.

Campuswide Updates & Changes: Current Assembly Areas

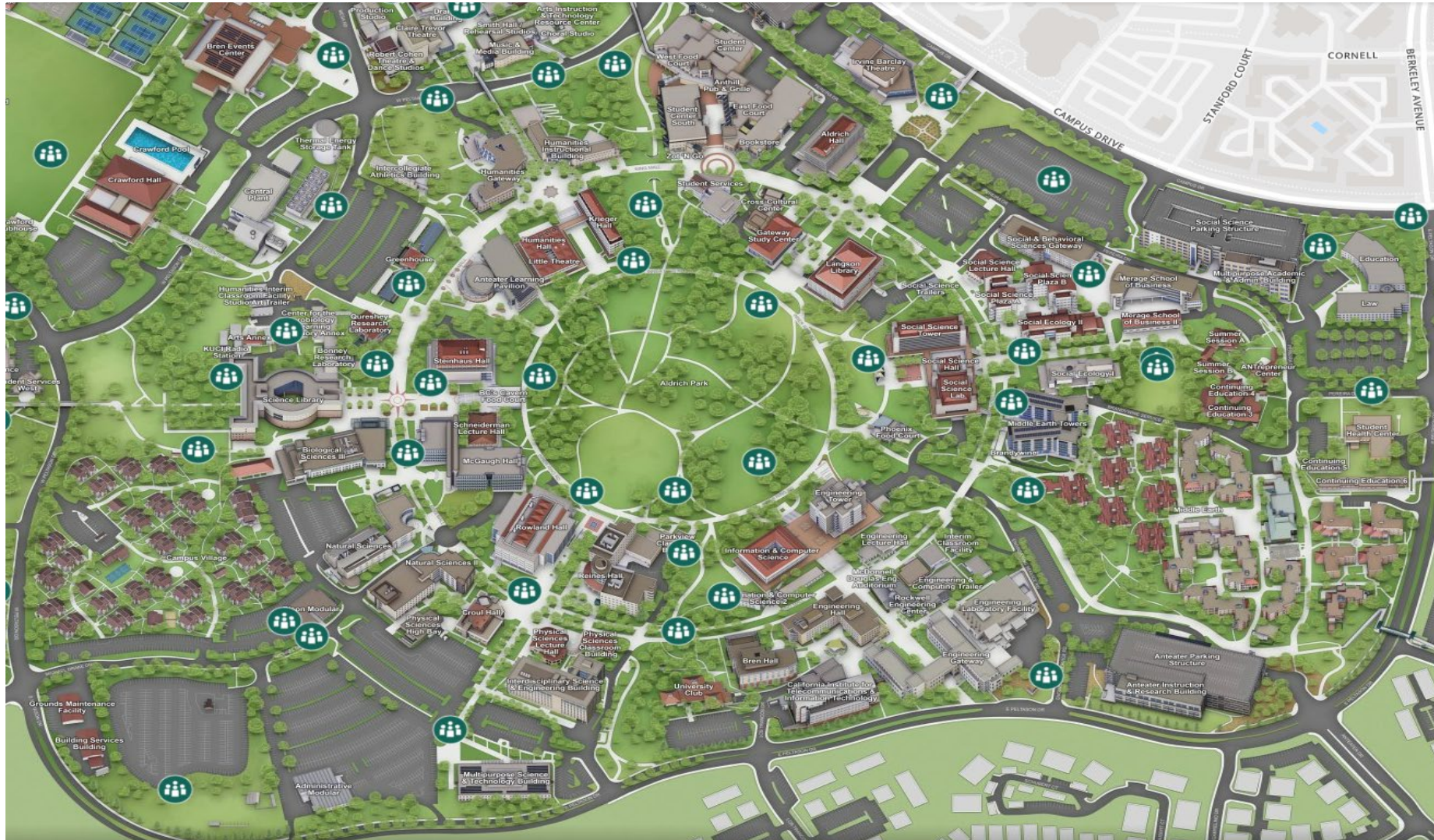

Campuswide Updates & Changes: New Assembly Areas

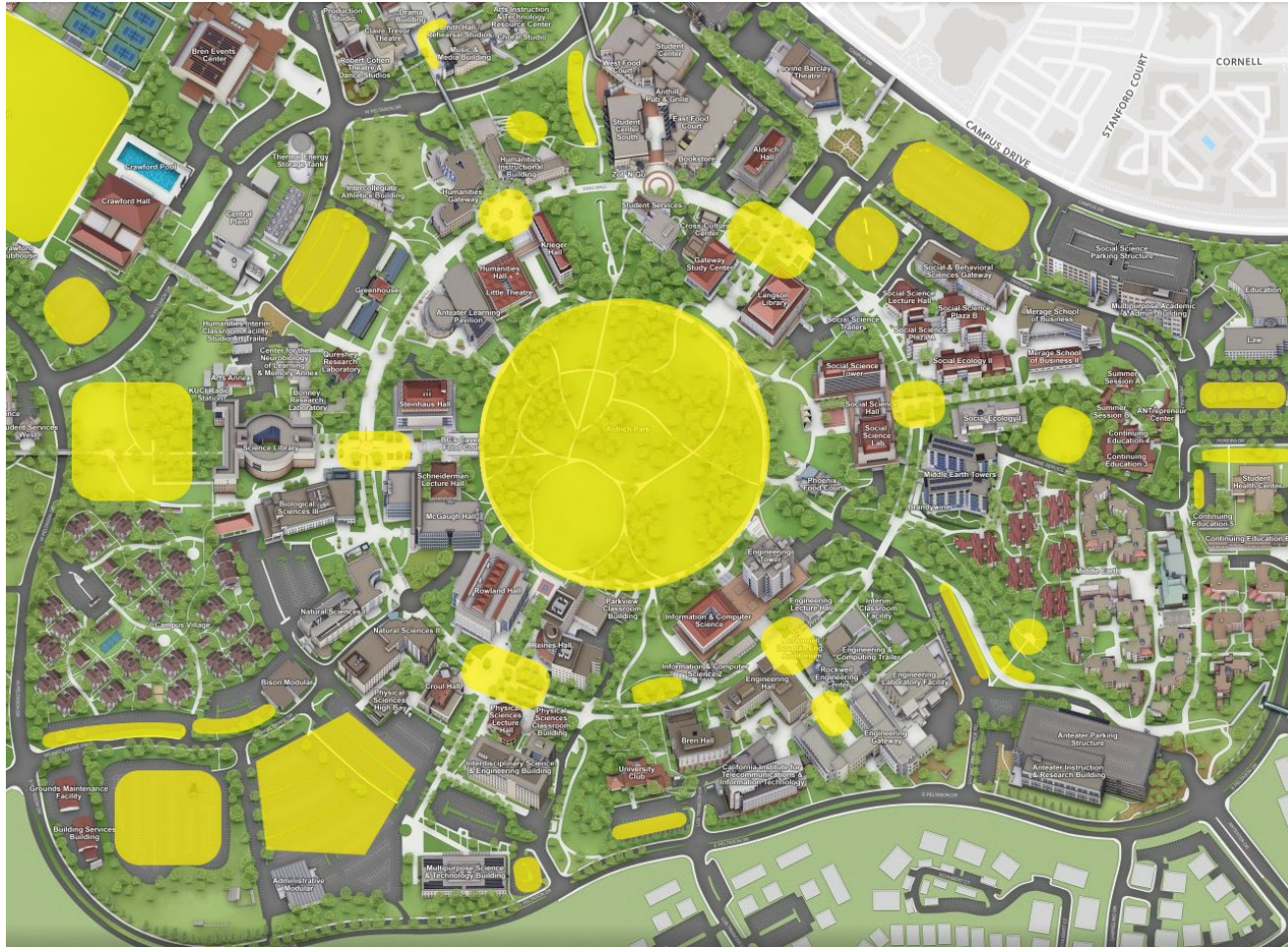

- New assembly areas feature large, open, flexible spaces away from first responders, fire lanes and fire hydrants.
- Any space between the building and first responders/staging area is not an appropriate assembly area.
- Many assembly areas were removed due to close proximity to buildings, fire hydrants or fire lanes.
- Buildings **no longer** have designated assigned assembly areas.
- ****NEW**** Assembly Area signs will be placed at all assembly areas, see below.



CSAR Updates & Changes

- ****NEW**** Name change from CSAR → CERT
 - Existing CSAR members do not need to do any additional training or recertification
 - CSAR was a federally recognized CERT team. Therefore no changes to training or curriculum are necessary.
- ****NEW**** Now offering a hybrid/online training course
 - Hosted by University of Utah, School of Medicine
 - Online lecture offered in English, **Spanish and Mandarin**
 - In-person, hands on skills assessment
- ****NEW**** CERT Leadership Team
 - Increased engagement
- Annual Exercises
- Engage local community partners
 - In partnership with the City of Irvine CERT and the CERT Mutual Aid Program we will be able to offer more opportunities such as trainings, exercises and activations
- Coming soon to our Training and Exercise website, an interactive calendar full of trainings or opportunities for individuals to sign up and participate.





UCI Evacuation Zones

UCI Division of Finance and Administration | With U • For U

Important Aspects of Evacuation

Know Your Zone

- ****NEW**** Interactive Evacuation Zone Map
- ****NEW**** Evacuation Terminology
- ****NEW**** Transportation Access Points
- ****NEW**** Evacuation Signage
- ****NEW**** EM Know Your Zone webpage

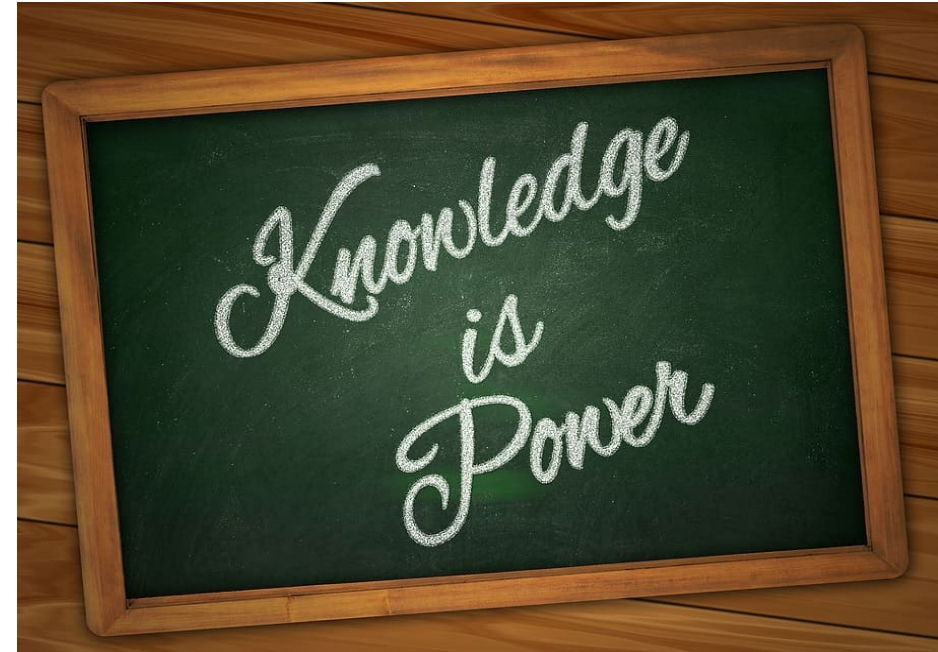

Interactive Evacuation Zone Map

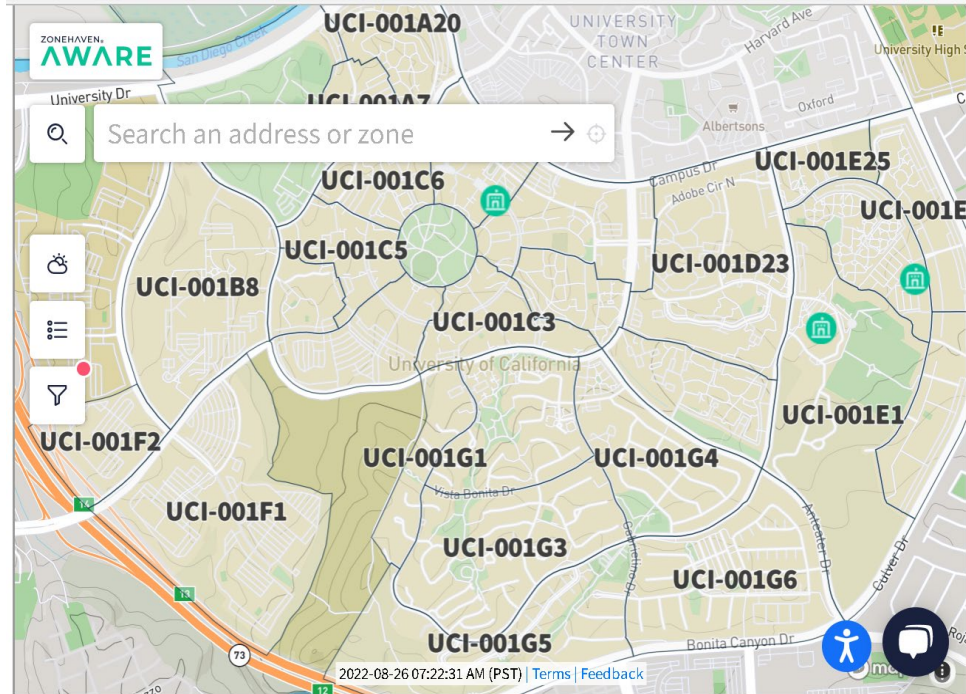

- Use the search bar on the top left corner of the map to type the address of your location and find your current zone information
- Double click your zone for useful information such as:
 - Zone Number
 - Zone Status
 - Reason for evacuation
 - What the area is commonly known for
 - Zone Boundaries
 - Useful links
 - Evacuation Information
 - Nearest Temporary Evacuation Site
 - Local Police and Fire Information

ZONE	UCI-001C1				
STATUS	Normal No current knowledge of active public safety incidents affecting your area.				
REASON	-				
COMMONLY KNOWN AS	Administration				
ZONE BOUNDARIES	ENGLISH SPANISH CHINESE SIMPLIFIED CHINESE TRADITIONAL NORTH OF Social Science Lecture Hall (SSLH), Graduate Resource Center (GRC) SOUTH OF Campus Drive, West Peltason Drive EAST OF Ring Mall WEST OF Social Science Lecture Hall (SSLH), Campus Drive				
USEFUL LINKS	EM Website Centralized resource for all things related to evacuation. Anteater Express TAP Locations Provides details on TAP locations and routes. Care and Shelter Registration Evacuees can register prior to arriving at a Care and Shelter site to expedite the registration process. UCI Emergency Updates Page This page will be updated throughout an incident to provide the most current information. zotALERT Sign Up zotALERT is an emergency alert system that uses cell phone text messaging to quickly notify the UCI community with safety information.				
<table border="0"> <tr> <td>EVACUATION INFO</td> <td>FIRE AND POLICE INFO</td> </tr> <tr> <td>Temporary Evacuation Points</td> <td>Care and Shelter - Anteater Recreation Center 680 California Ave, Irvine, CA 92617</td> </tr> </table>		EVACUATION INFO	FIRE AND POLICE INFO	Temporary Evacuation Points	Care and Shelter - Anteater Recreation Center 680 California Ave, Irvine, CA 92617
EVACUATION INFO	FIRE AND POLICE INFO				
Temporary Evacuation Points	Care and Shelter - Anteater Recreation Center 680 California Ave, Irvine, CA 92617				

Evacuation Terminology

- **Evacuation Warning** – all persons and their animals in the evacuation area should relocate to safer locations; those with access and functional needs should leave immediately
- **Immediate Evacuation Order** – areas that are being required to evacuate due to the close proximity to the threat; **mandatory evacuation**
- **Voluntary Evacuation** – areas that are not directly impacted by the threat, but may choose to evacuate as a precautionary measure
- **Shelter-in-Place** – all persons and their animals are to remain indoors during or following an emergency event
- **Transportation Access Point (TAP)** – a hub where evacuees can be picked up by university transportation to care and reception / shelter areas
- **Repopulation** – coordinated effort by OCFA, EM, and T&DS to allow residents to return to their homes

Transportation Access Points

During an evacuation, you may be directed to a designated care and reception / shelter location off campus.

If you do not have means of transportation to evacuate, the campus will provide transportation assistance utilizing our Transportation Access Points (TAPs).

TAPs are pre-designated locations around the campus perimeter where the campus community can access transportation assistance during an evacuation.

Most designated TAPs are bus stops, however, not every bus stop is a TAP. TAP signs indicate which areas are TAP locations and which are not. You can also access the TAP location map at [Anteater Express \(uci.edu\)](https://www.uci.edu/transportation-access-points).



This sign indicates this is a TAP location.

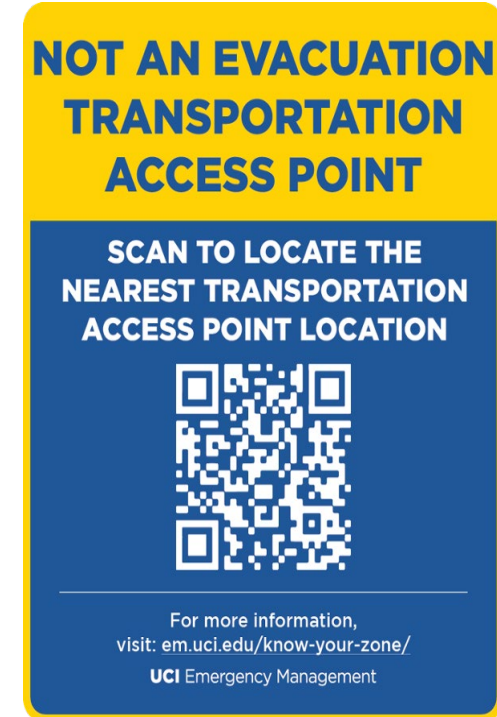

This sign indicates this is **NOT** a TAP location.

Evacuation Signage

During emergencies, evacuations will be issued based on the zones that are currently impacted. It's important to be familiar with the zone you live and/or work in and be familiar with where to obtain the zone's information. You can find evacuation signage placed both inside a facility and outside across campus to ensure you can quickly access this information during an emergency.



Zone Sign

Signs are placed outdoors, across campus indicating zone information.



Assembly Area

Signage placed at the assembly area locations across campus.

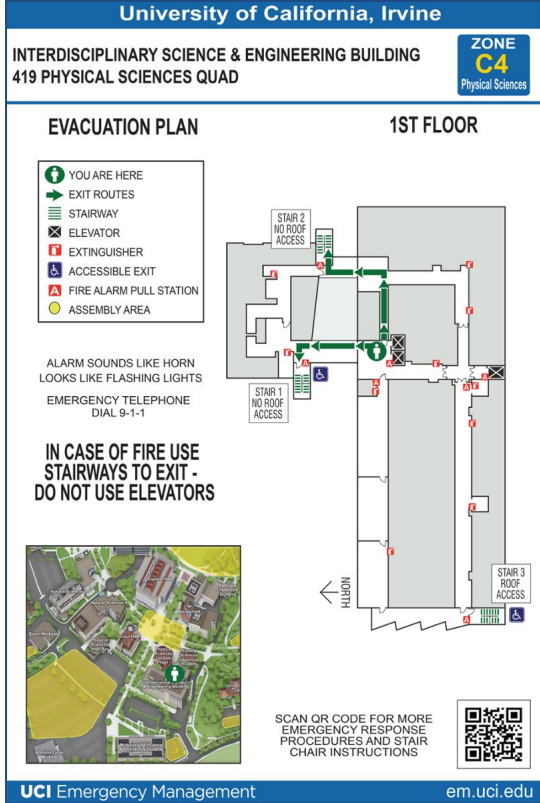

Emergency Action Plan (EAP)

Sign placed indoors indicating zone information, assembly area location, evacuation plan, and emergency response procedures

Know Your Zone Website

New website that hosts everything you need to know about evacuation and zone information. Links for:

- Evacuation Zone Map
- Evacuation Signage
- Evacuation Terminology
- Evacuation Notifications
- Transportation Access Points
- TAP Procedures
- Repopulation Procedures
- Care and Reception / Shelter Areas
- Assembly Areas
- Assembly Area Map
- What can you do to be prepared?

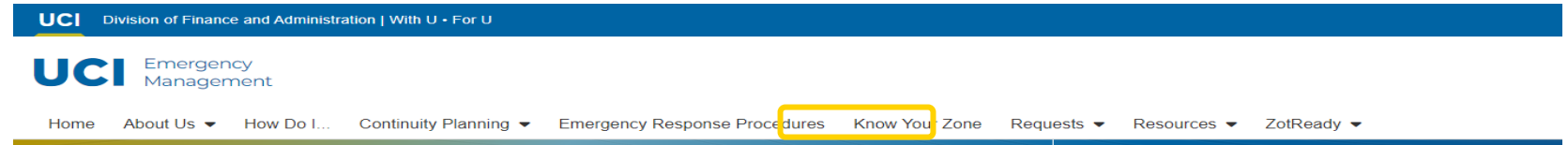

- Evacuation Zone Map [↗](#)
- Evacuation Signage
- Evacuation Terminology and Protective Actions
- Evacuation Notifications
- Transportation Access Point (TAP) Map [↗](#)
- TAP Procedures
- Repopulation Procedures
- Care and Reception / Shelter Areas
- Assembly Area
- Assembly Area Map
- What can you do to be prepared?

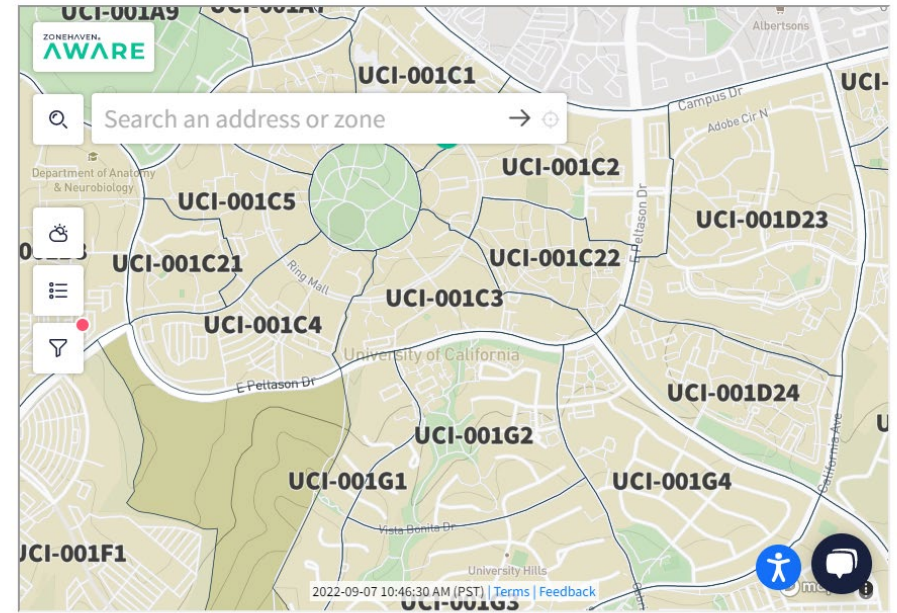

Zone Identifier Breakdown EX: UCI-001G5 UCI-001 = Main Campus G5 = Zone Identifier

Important Resources to Stay Informed

- ZotAlert Text Message
- ZotAlert Email
- Alertus Desktop
- Alertus Classroom Beacons
- ****NEW**** UCI Emergency Update Website
- Social Media
- AM 1690
- Regional Disaster Information Hotline

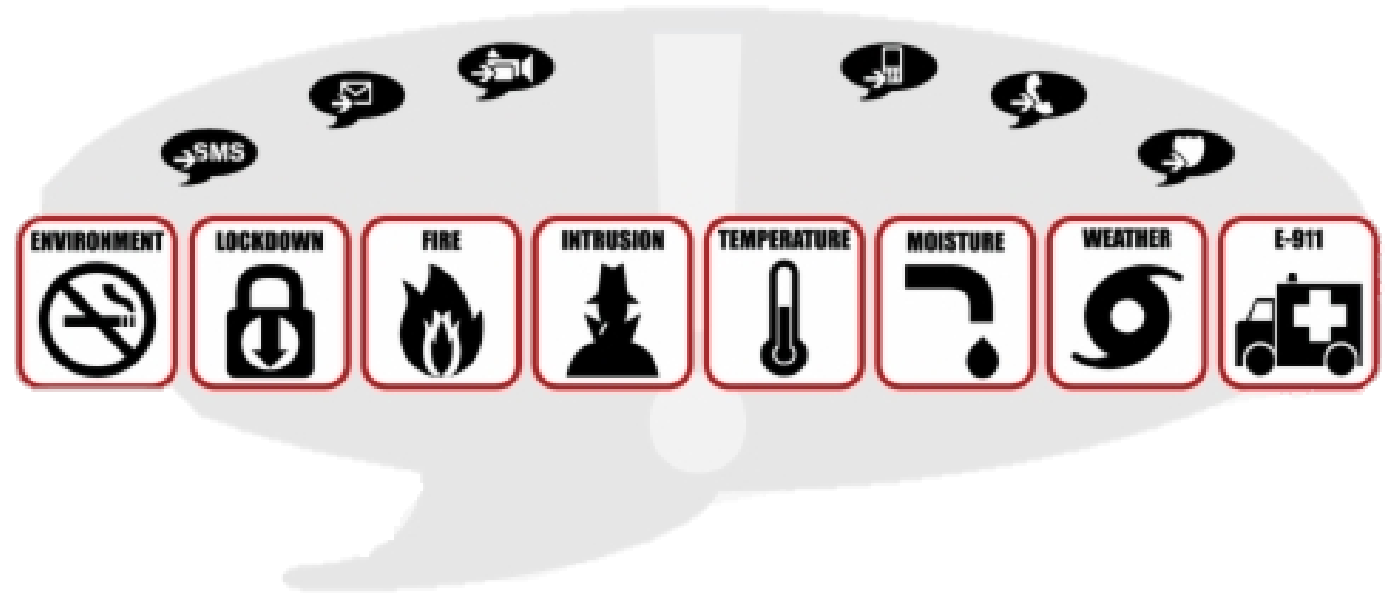

zotALERT Text Message & Email

zotALERT Text Messages

The zotALERT emergency alert system is an opt-in system. **All students and employees are strongly encouraged to sign up for zotALERT to be alerted to emergencies on campus.** You will need a “text-enabled” mobile phone. Use this link to learn [How to sign up for zotALERT.](#)

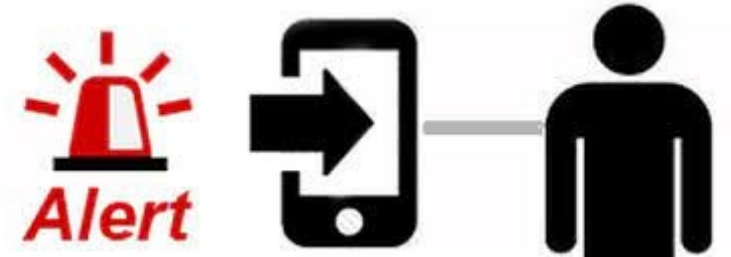

zotALERT Email

The zotALERT text message system is complemented by the zotMail email system, which is a mandatory element of campus emergency communications, as described on the [zotMail website.](#)

Alertus Desktop and Classroom Beacons

Alertus Desktop Pop-Up Emergency Notifications

The Alertus notification system enables UCI students, faculty, and staff to receive emergency messages (sent via zotALERT) as a pop-up message on their desktop or laptop. Follow the link to learn [How to install the Alertus Desktop software](#).



Alertus Classroom Beacons

[Alertus Emergency Alert Beacons](#) have been installed in several of the largest lecture halls on campus. When UCIPD issues a campus zotALERT, the beacon will make an audible sound, have flashing lights and the text of the zotALERT will be displayed on the screen. The alerts should be treated exactly the same way as the zotALERT text message. Follow the instructions provided via the beacon, text message, email, and/or desktop alert (i.e. evacuate, secure-in-place, stay away from the area, etc.).

UCI Emergency Updates Website and Social Media

Updates on [UCI Emergency Updates](#) may include, but are not limited to:

- zotALERT messages and updates
- Information pertaining to a major emergency or disaster affecting the local community
- Updates on long-term or ongoing UCI related emergencies or disasters
- Links to UCI social media where more up to date information may be found



Emergency Updates

Currently, there are no emergencies or emergency communications in effect.

To report an emergency, call 911 or the UCI Police Department at [949-824-5223](tel:949-824-5223)

➔ [UCI on Facebook](#)

➔ [UCI Police on Facebook](#)

➔ [Earthquake Preparedness](#)

University of California, Irvine

➔ [UCI on Twitter](#)

➔ [UCI Police on Twitter](#)

➔ [Public Health Emergency Preparation and Response](#)

Irvine, CA 92697
949-824-5011

Regional Disaster Information Resources

Activated only after a disaster, the UCI Disaster Information Hotline, 866-IRV-NEWS (866-478-6397), is a recorded message for the public to call and receive a brief voice message of the status of the campus. Information regarding the status of the campus, employees, and students will be available through this number.

DO NOT CALL THIS NUMBER TO REPORT AN EMERGENCY.

For area wide emergency alerts:



For area wide emergency information and instructions, tune to any of the follow:

- Local KUCI: www.kuci.org and 88.9 FM
- UCI Zot Radio: WQTB 1690 AM
- Orange County Radio Station: KWVE 107.9 FM
- Los Angeles County Radio Stations: KFI 640 AM, KNX 1070 AM, KFWB 980 AM

Zot Radio – AM1690

- The radio system's primary function is to provide traffic conditions, alerts, emergency news and information should the campus experience a natural or manmade disaster or other emergency that would require quick dissemination of information and action by the campus community.
- In the case of an emergency or Zotalert, the radio may broadcast information about evacuation instructions, shelter-in-place, or other directives related to the alert. The station broadcasts 24 hours a day, seven days a week.
- Signs advising travelers of UC Irvine's Zotradio are posted on traffic poles at the five main campus entrances:
 - ❖ **East Peltason Drive and Pereira Drive**
 - ❖ **East Peltason Drive and Anteater Drive**
 - ❖ **East Peltason Drive and Michael Drake Drive**
 - ❖ **West Peltason Drive and Mesa Road**
 - ❖ **West Peltason Drive and Pereira Drive**



Thank you!

Questions or comments?